

# Isoglide

## SINGLE STAGE, END SUCTION PUMP

### PUMP OVERVIEW

The ClydeUnion Pumps Isoglide range of horizontal long coupled or close coupled ISO 2858 standard pumps is an established end suction design range:

- 32 individual pump frame sizes divided into 4 modular shaft groupings
- Numerous sealing options available
- Back pull-out design allows for easy removal of the pump rotating element without disturbing the pipework ensuring ease of maintenance
- Material options available for non-corrosive and corrosive applications including seawater
- Designed for both 50Hz and 60Hz markets



### TYPICAL APPLICATIONS

- Water treatment, supply + distribution
- Desalination
- District heating + district cooling
- Irrigation
- De-watering
- Power auxiliaries
- Paper manufacturing
- Mining
- Metal manufacturing
- Chemical + petrochemical industries
- General industrial applications
- Building services

### TECHNICAL DATA

- Capacity:** up to 1,000 m<sup>3</sup>/hr / 4,400 USgpm
- Delivery head:** up to 200 m / 670 ft
- Temperature:** up to 120 °C / 250 °F
- Speeds:** up to 3,600 rpm
- Flange drilling:** ANSI or BS

MATERIAL SPECIFICATION	CASING	IMPELLER	SHAFT
SPEC J	Cast Iron	Stainless Steel	Stainless Steel
SPEC A8	Stainless Steel	Stainless Steel	Super Duplex
SPEC D1	Duplex	Duplex	Super Duplex
SPEC D2	Super Duplex	Super Duplex	Super Duplex

Please Note: A wide range of additional materials are available on request

## FEATURES + BENEFITS

- 1 **Low energy costs**  
Hydraulic design provides high efficiency, low NPSH and stable characteristics
- 2 **Optimum seal performance**  
Single, double and cartridge options. Packed gland available on request
- 3 **Extended bearing life**  
Choice of bearing - single or double, grease or oil lubricated (only for long-coupled bearing)
- 4 **Ease of maintenance**  
Back pull-out design allows full access without disturbing site pipework or driver
- 5 **Low power consumption**  
Shrouded impeller design provides high efficiency and low hydraulic thrust
- 6 **Wear options**  
Casing and impeller wear rings and shaft sleeve available as optional configurations
- 7 **Modular design**  
Minimises spares holding of back pull-out components
- 8 **Centre line discharge**  
Self venting casing design prevents air entrapment in the top of the casing
- 9 **Simplified build procedures**  
Spigot design facilitates self setting axial clearance

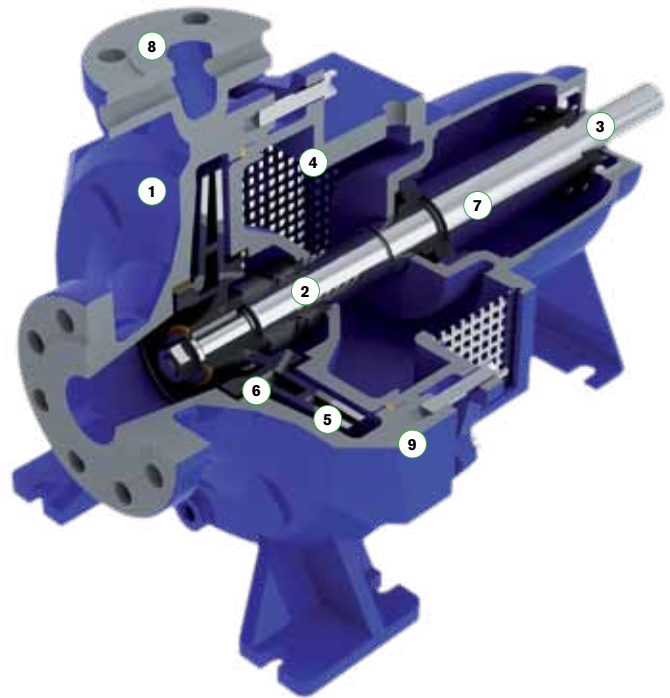

## RANGE COVERAGE CHARTS

50HZ RANGE CHART

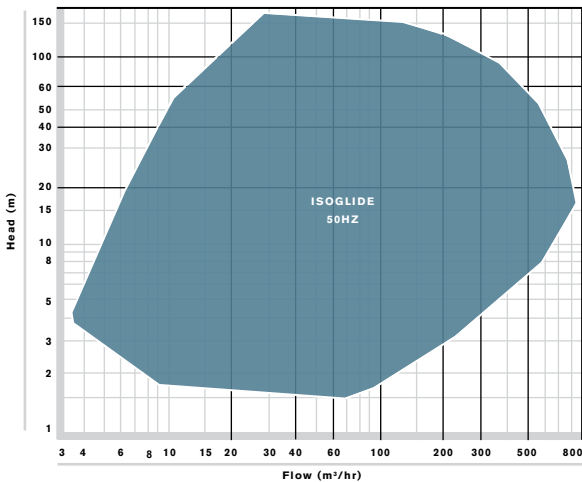

60HZ RANGE CHART

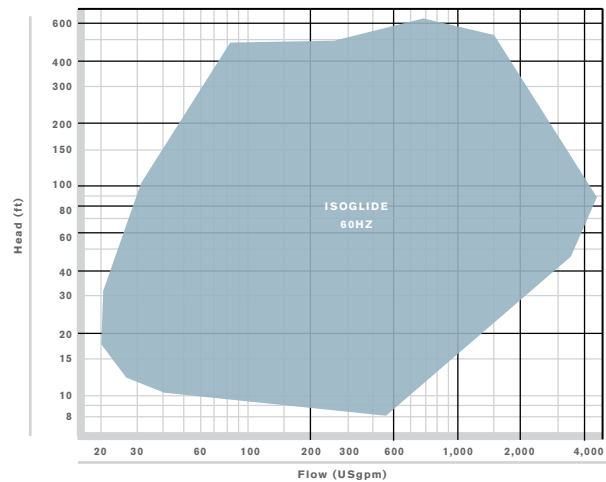

These charts cover the standard pump range. Other engineering designs exist for extreme applications

**SPX**

P: +44 (0)141 637 7141 F: +44 (0)141 633 2399 E: cu.sales@spx.com

For more information about our worldwide locations, approvals, certifications, and local representatives, please visit [www.spx.com](http://www.spx.com).

SPX Corporation reserves the right to incorporate our latest design and material changes without notice or obligation. Design features, materials of construction and dimensional data, as described in this bulletin, are provided for your information only and should not be relied upon unless confirmed in writing.

CUP-04-ISO-UK-02

COPYRIGHT © 2012 SPX Corporation